

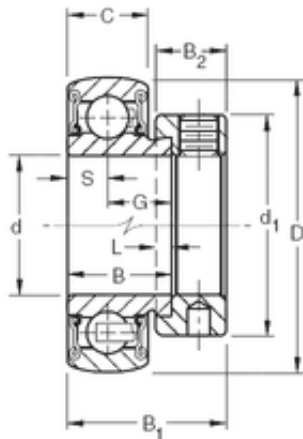

# CONSOLIDATED BEARING trading LTD

## 42,8625 mm x 85 mm x 30,18 mm TIMKEN RA111RRB Insert Bearings Spherical OD



Bearing No. RA111RRB

Size	42.8625x85x30.18 mm
Bore Diameter	42,8625 mm
Outer Diameter	85 mm
Width	30,18 mm
d	42,8625 mm
D	85 mm
B	30,18 mm
C	22 mm
d1	63,5 mm
B1	43,7 mm
B2	18,3 mm
G	19,18 mm
L	4,8 mm
S	11 mm
Weight	0,735 Kg
Basic dynamic load rating (C)	36 kN

RA111RRB Bearing 2D drawings and 3D CAD models